

Soils Map

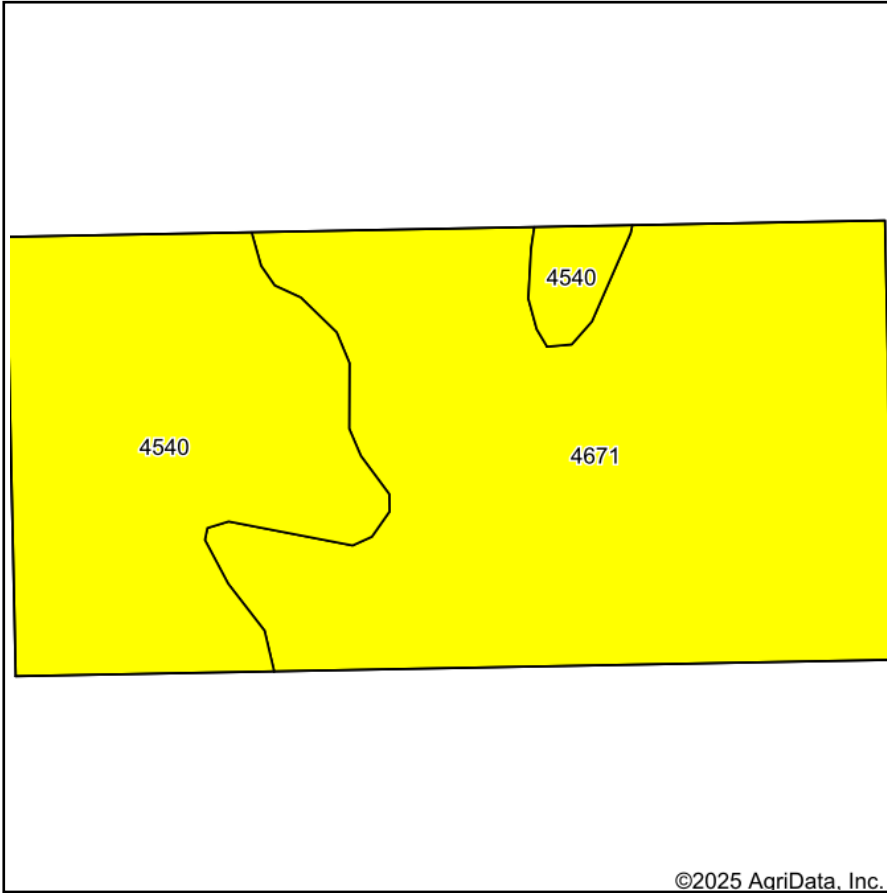

©2025 AgriData, Inc.

Soils data provided by USDA and NRCS.

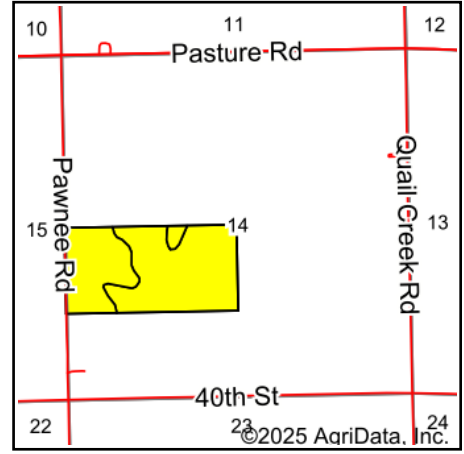

State: **Kansas**
 County: **Marion**
 Location: **14-22S-3E**
 Township: **Peabody**
 Acres: **80**
 Date: **1/3/2025**

Maps Provided By:

 CUSTOMIZED ONLINE MAPPING
 © AgriData, Inc. 2023 www.AgriDataInc.com



Area Symbol: KS115, Soil Area Version: 22

Code	Soil Description	Acres	Percent of field	Non-Irr Class Legend	Non-Irr Class *c	Irr Class *c
4671	Irwin silty clay loam, 1 to 3 percent slopes	51.33	64.2%		III _s	III _s
4540	Clime silty clay loam, 1 to 3 percent slopes	28.67	35.8%		III _e	III _e
Weighted Average					3.00	3.00

*c: Using Capabilities Class Dominant Condition Aggregation Method