

Soils Map

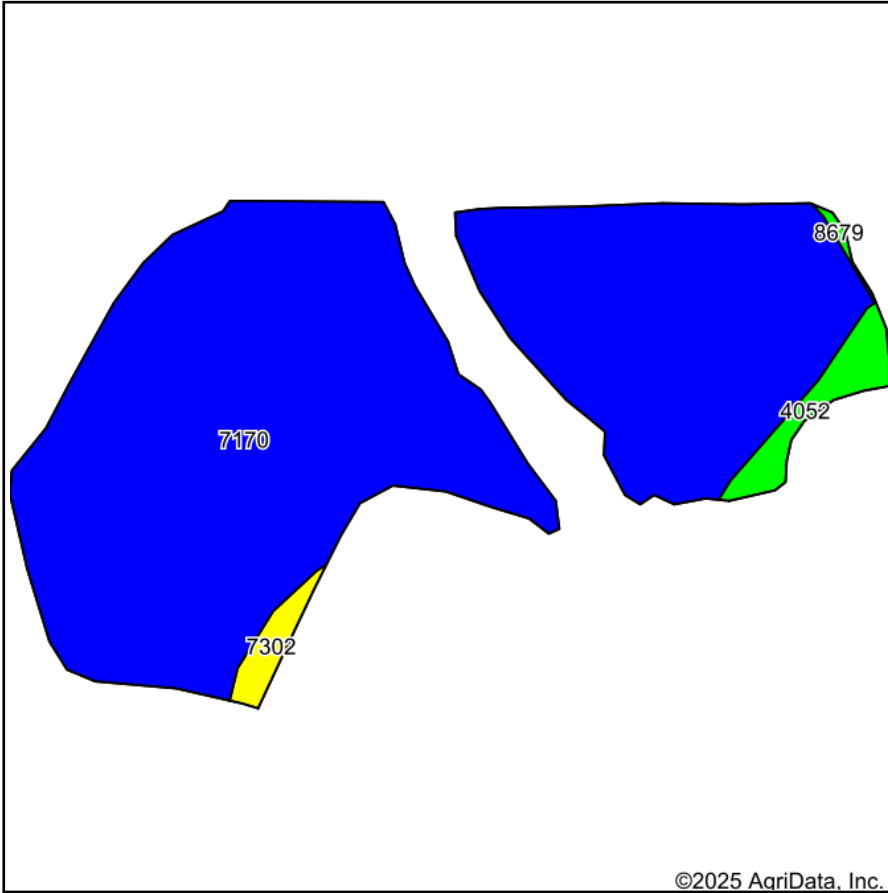

Soils data provided by USDA and NRCS.

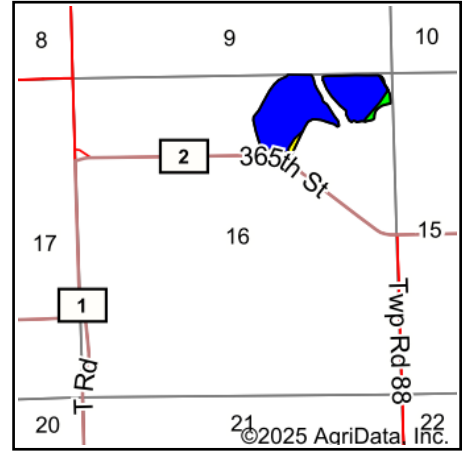





State: **Kansas**
 County: **Greenwood**
 Location: **16-22S-11E**
 Township: **Madison**
 Acres: **38.79**
 Date: **1/30/2025**

Maps Provided By:

 CUSTOMIZED ONLINE MAPPING
 © AgriData, Inc. 2023 www.AgriDataInc.com

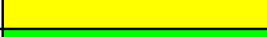

Area Symbol: KS073, Soil Area Version: 22

Code	Soil Description	Acres	Percent of field	Non-Irr Class Legend	Non-Irr Class *c	Irr Class *c
7170	Reading silt loam, rarely flooded	36.88	95.1%		Iw	Iw
4052	Ivan silt loam, occasionally flooded	1.20	3.1%		IIw	IIw
7302	Martin silty clay loam, 3 to 7 percent slopes	0.62	1.6%		IIIe	IIIe
8679	Dennis silt loam, 1 to 3 percent slopes	0.09	0.2%		Ile	
Weighted Average					1.07	*-

*c: Using Capabilities Class Dominant Condition Aggregation Method

*- Irr Class weighted average cannot be calculated on the current soils data due to missing data.